

** Not all features are shown in this drawing. For more detailed information, please contact your Fair-Rite representative.

UNCONTROLLED ~CATALOG~ DRAWING

SIZE	PART NO.	REV.
B	5943002701	~

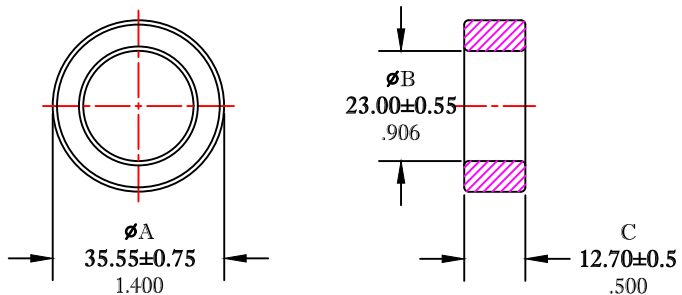

DIMENSIONS
BOLD NUMBERS ARE IN MILLIMETERS
 LIGHT NUMBERS ARE IN INCHES

ELECTRICAL SPECIFICATIONS						
$\Sigma l/A(mm^{-1})$	$le (mm)$	$Ae (mm^2)$	$Ve (mm^3)$	$Lo (nH)$	$AL (nH)$ @10 kHz <10gauss	$\tan \delta/\mu_1$ @100 kHz 1gauss
1.1361	89.1	78.4	6991	1.106	885±20%	$\leq 40 \times 10^{-6}$

NOTES:

- 1 - FR# 43 MATERIAL, OR APPROVED EQUIVALENT.
- 2 - BURNISH TO BREAK SHARP EDGES.
- 3 - ELECTRICAL TESTS PERFORMED AS PER SOP# ELC-35.

FR# 43

FAIR-RITE PRODUCTS CORP.						
TITLE TOROID						
DRAWN BY J.SERENCIS	DATE 07-17-2018	SIZE	PART NO.	REV.		
CHKD BY		B	5943002701	~		
APPRVD BY		SCALE	NONE	SHEET	1 of 1	