

** Not all features are shown in this drawing. For more detailed information, please contact your Fair-Rite representative.

UNCONTROLLED ~CATALOG~ DRAWING

SIZE	PART NO.	REV.
B	9495207002	~

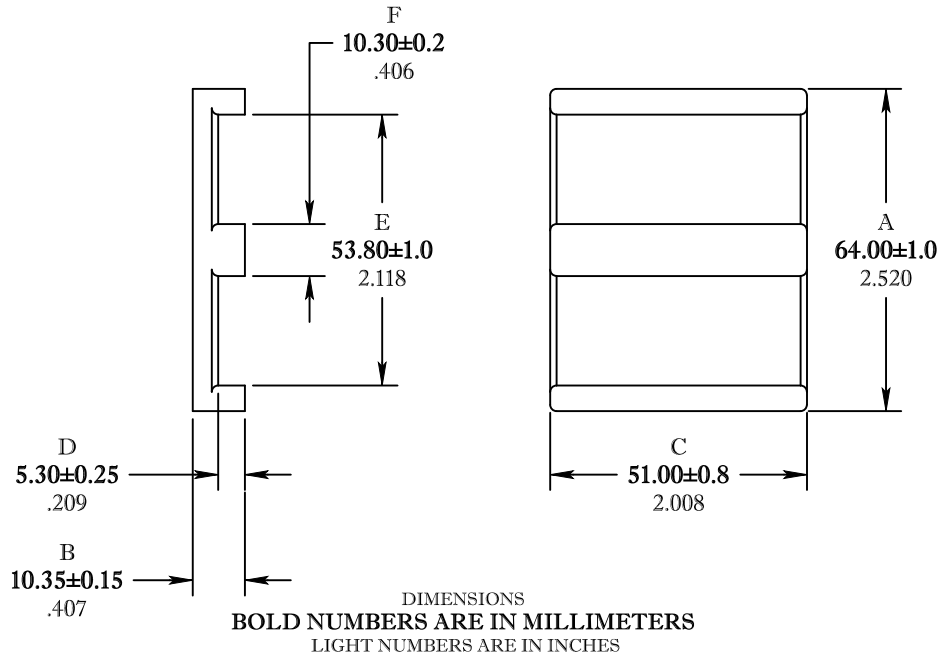

ELECTRICAL SPECIFICATIONS					
$\Sigma l/A(\text{cm}^{-1})$	$l_e(\text{cm})$	$A_e(\text{cm}^2)$	$V_e(\text{cm}^3)$	$A_{\text{MIN}}(\text{cm}^2)$	AL (nH) @1kHz <10gauss
0.154	80.7	520	41500	515	18000±25%
MATE PAIR; CLAMPING FORCE = 20 lbs.					

POWER LOSS @ 25°C [PER SET]
 f = 100kHz, 2000g P.L. < 26 Watts

POWER LOSS @ 100°C [PER SET]
 f = 100kHz, 2000g P.L. < 26 Watts

FAIR-RITE PRODUCTS CORP.					
TITLE PLANAR "E" CORE					
DRAWN BY J.SERENCICS	DATE 07-11-2018	SIZE B	PART NO. 9495207002	REV. ~	
CHKD BY		APPRVD BY	SCALE NONE	SHEET 1 of 1	

FR# 95