

\*\* Not all features are shown in this drawing. For more detailed information, please contact your Fair-Rite representative.

UNCONTROLLED ~CATALOG~ DRAWING

SIZE	PART NO.	REV.
B	9495204002	~

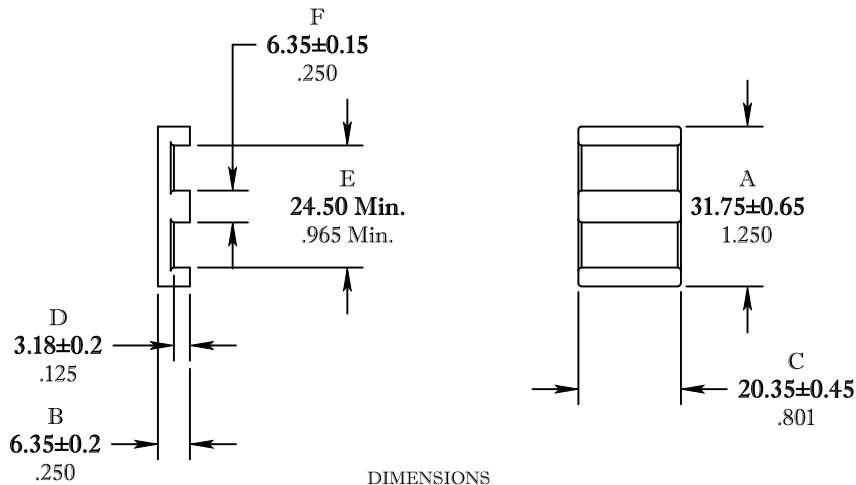

DIMENSIONS  
**BOLD NUMBERS ARE IN MILLIMETERS**  
 LIGHT NUMBERS ARE IN INCHES

ELECTRICAL SPECIFICATIONS				
$\Sigma l/A(mm^{-1})$	$l_e (mm)$	$A_e (mm^2)$	$V_e (mm^3)$	$A_L (nH)$ @ 1 kHz <10gauss
0.32	41.7	129	5380	7600±25%
MATE PAIR CLAMPING FORCE = 7 lbs				

POWER LOSS @ 25°C [PER SET]  
 f = 100kHz, 2000g P.L. < 3.4 Watts

POWER LOSS @ 100°C [PER SET]  
 f = 100kHz, 2000g P.L. < 3.0 Watts

<b>FAIR-RITE PRODUCTS CORP.</b>				
TITLE PLANAR "E" CORE				
DRAWN BY J.SERENCISCS	DATE 07-11-2018	SIZE B	PART NO. 9495204002	REV. ~
CHKD BY				
APPRVD BY		SCALE NONE	SHEET 1 of 1	

FR# 95