

\*\* Not all features are shown in this drawing. For more detailed information, please contact your Fair-Rite representative.

UNCONTROLLED ~CATALOG~ DRAWING

SIZE	PART NO.	REV.
B	7878400721	~

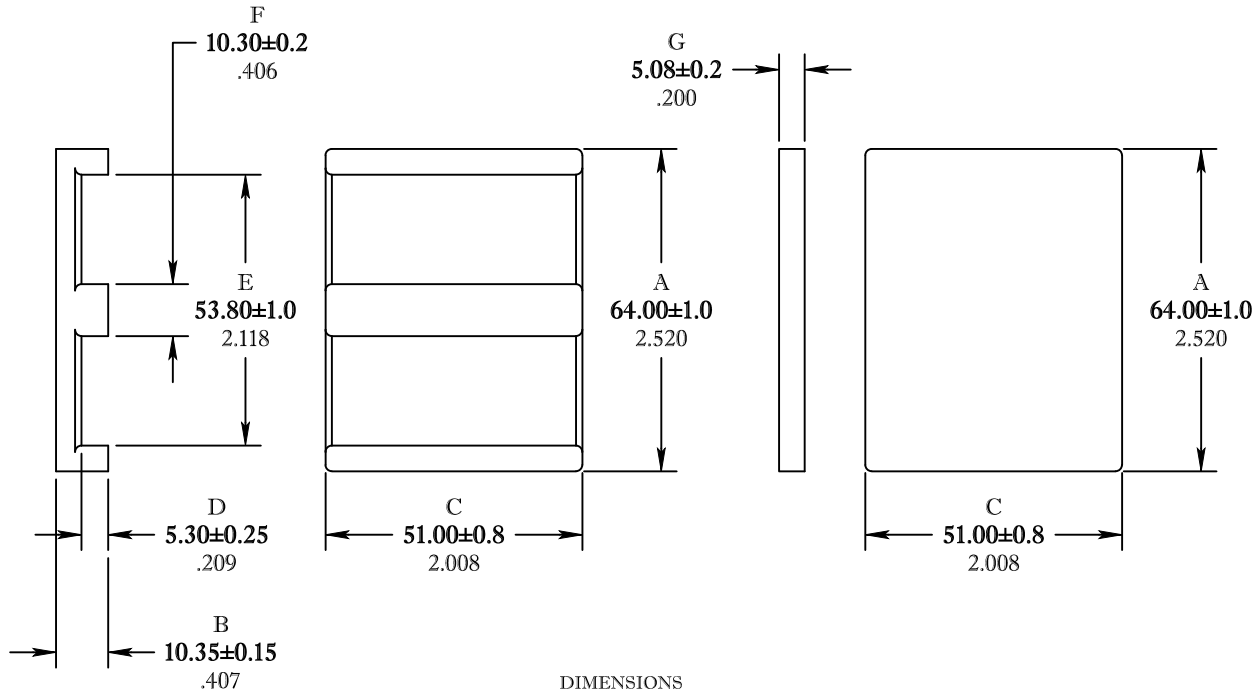

DIMENSIONS  
**BOLD NUMBERS ARE IN MILLIMETERS**  
 LIGHT NUMBERS ARE IN INCHES

ELECTRICAL SPECIFICATIONS				
$\Sigma l/A (\text{mm}^{-1})$	$l_e (\text{mm})$	$A_e (\text{mm}^2)$	$V_e (\text{mm}^3)$	$A_L (\text{nH})$ @ 1 kHz <10gauss
0.14	70	518	36330	16900 ± 25%
CORE SET CLAMPING FORCE = 20 lbs				

POWER LOSS @ 100°C  
 f = 100kHz, 2000g P.L. < 23 Watts

<b>FAIR-RITE PRODUCTS CORP.</b>				
TITLE PLANAR "EI" CORE SET				
DRAWN BY J.SERENCSCIS	DATE 07-11-2018	SIZE B	PART NO. 7878400721	REV. ~
CHKD BY				
APPRVD BY		SCALE NONE	SHEET 1 of 1	

FR# 78