

** Not all features are shown in this drawing. For more detailed information, please contact your Fair-Rite representative.

SIZE	PART NO.	REV.
B	9580200602	~

UNCONTROLLED ~CATALOG~ DRAWING

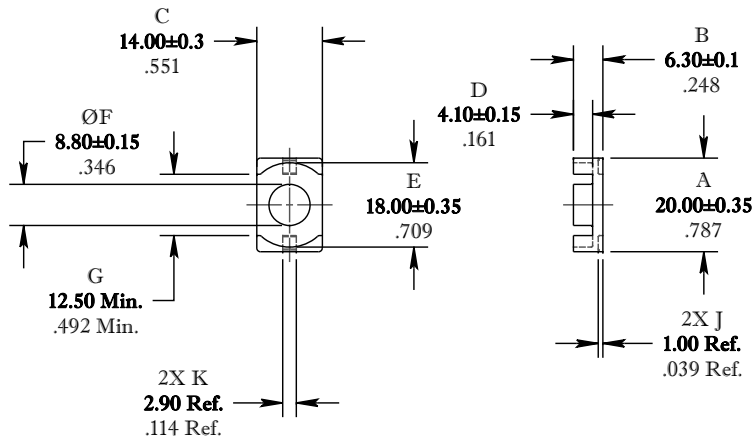

DIMENSIONS
BOLD NUMBERS ARE IN MILLIMETERS
 LIGHT NUMBERS ARE IN INCHES

ELECTRICAL SPECIFICATIONS						
$\Sigma l/A(\text{mm}^{-1})$	l_e (mm)	A_e (mm ²)	A_{Min} (mm ²)	V_e (mm ²)	A_L (nH) @ 10 kHz <10gauss	$\tan \delta/\mu_i$ @ 1 MHz <1gauss
0.553	33.3	60.0	55.0	2000	1210±25%	≤20X10E-6
MATE PAIR: CLAMPING FORCE = 5 lbs.						

POWER LOSS @ 25°C
 f = 1 MHz, 500g. f = 3 MHz, 150g.
 Measure & Record

FR# 80

FAIR-RITE PRODUCTS CORP.						
TITLE "EQ" CORE						
DRAWN BY D. FOOTE	DATE 3/19/2019	SIZE	PART NO.	REV.		
CHKD BY		B	9580200602	~		
APPRVD BY		SCALE	NONE	SHEET	1 of 1	