

\*\* Not all features are shown in this drawing. For more detailed information, please contact your Fair-Rite representative.

UNCONTROLLED ~CATALOG~ DRAWING

SIZE	PART NO.	REV.
B	6578170121	~

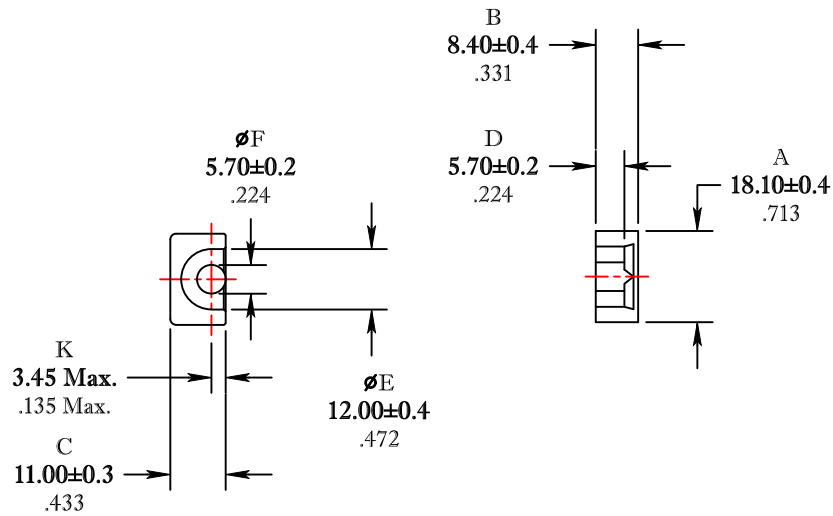

DIMENSIONS  
**BOLD NUMBERS ARE IN MILLIMETERS**  
 LIGHT NUMBERS ARE IN INCHES

ELECTRICAL SPECIFICATIONS					
$\Sigma l/A(\text{cm}^{-1})$	$l_e(\text{cm})$	$A_e(\text{cm}^2)$	$V_e(\text{cm}^3)$	$A_{\text{MIN}}(\text{cm}^2)$	$A_L(\text{nH})$ @1kHz <10gauss
8	2.68	0.336	899	0.252	2250±25%
MATE PAIR; CLAMPING FORCE = 5 lbs.					

POWER LOSS @ 100°C  
 f = 100kHz, 2000g P.L. < 0.6 Watts

<b>FAIR-RITE PRODUCTS CORP.</b>					
TITLE					
EP CORE					
DRAWN BY J.SERENCISCS	DATE 07-12-2018	SIZE	PART NO.	REV.	
CHKD BY		B	6578170121	~	
APPRVD BY		SCALE	NONE	SHEET 1 of 1	

FR# 78