

\*\* Not all features are shown in this drawing. For more detailed information, please contact your Fair-Rite representative.

UNCONTROLLED ~CATALOG~ DRAWING

SIZE	PART NO.	REV.
B	9567130302	~

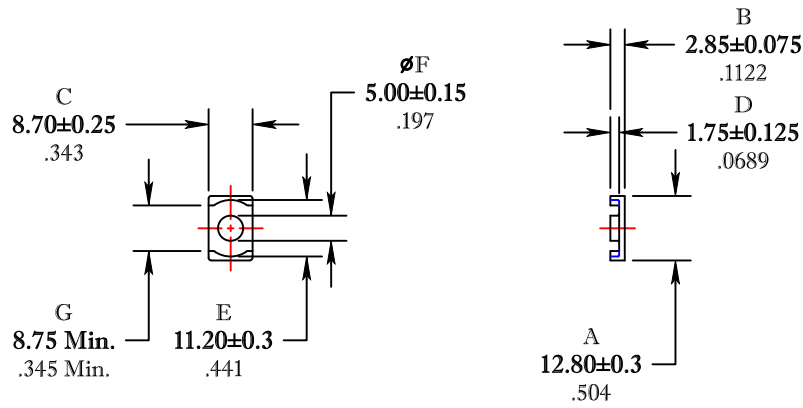

DIMENSIONS  
**BOLD NUMBERS ARE IN MILLIMETERS**  
 LIGHT NUMBERS ARE IN INCHES

ELECTRICAL SPECIFICATIONS						
$\Sigma l/A(\text{mm}^{-1})$	$l_e$ (mm)	$A_e$ (mm <sup>2</sup> )	$A_{\text{Min}}$ (mm <sup>2</sup> )	$V_e$ (mm <sup>3</sup> )	$A_L$ (nH) @10kHz <10gauss	$Q$ @ 50MHz <1gauss
0.856	17.4	20.0	19.2	348	45 Min.	> 50
MATE PAIR: CLAMPING FORCE = 3 lbs.						

POWER LOSS @ 25°C

f = 5 MHz, 100g P.L. < 0.04 Watts  
 f = 10 MHz, 100g P.L. < 0.12 Watts

<b>FAIR-RITE PRODUCTS CORP.</b>						
TITLE "EQ" CORE						
DRAWN BY J.SERENCSCS	DATE 07-12-2018	SIZE B	PART NO. 9567130302		REV. ~	
CHKD BY						
APPRVD BY		SCALE	NONE	SHEET	1 of 1	

FR# 67