

\*\* Not all features are shown in this drawing. For more detailed information, please contact your Fair-Rite representative.

UNCONTROLLED ~CATALOG~ DRAWING

SIZE	PART NO.	REV.
B	6595070121	~

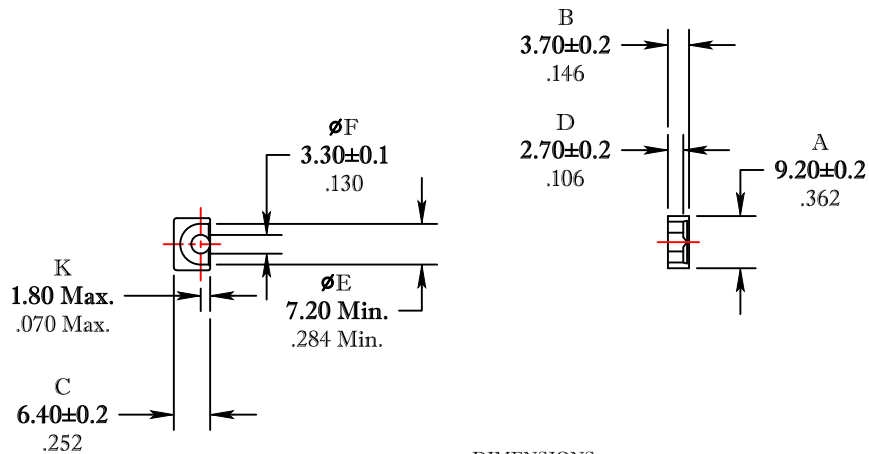

DIMENSIONS  
**BOLD NUMBERS ARE IN MILLIMETERS**  
 LIGHT NUMBERS ARE IN INCHES

ELECTRICAL SPECIFICATIONS					
$\Sigma l/A(\text{cm}^{-1})$	$l_e(\text{cm})$	$A_e(\text{cm}^2)$	$V_e(\text{cm}^3)$	$A_{\text{MIN}}(\text{cm}^2)$	$A_L(\text{nH})$ @1kHz <10gauss
14.4	1.48	0.103	0.152	0.085	1180±25%
MATE PAIR; CLAMPING FORCE = 5 lbs.					

POWER LOSS @ 25°C

f = 100kHz, 2000g P.L. < 0.075 Watts

POWER LOSS @ 100°C

f = 100kHz, 2000g P.L. < 0.075 Watts

<b>FAIR-RITE PRODUCTS CORP.</b>					
TITLE					
EP CORE					
DRAWN BY J.SERENCIS	DATE 07-12-2018	SIZE	PART NO.	REV.	
CHKD BY		B	6595070121	~	
APPRVD BY		SCALE	NONE	SHEET 1 of 1	

FR# 95